

Countersunk Head Articulated Bolt For Insulated Glass Units (Model: KSP.R1001A-V-1465)

These items are not held in stock and will require approximately 1-2 weeks delivery time



Attributes:

Product Code: KSP.R1001A-V-1465

Unit Of Sale: Each

Dimensions

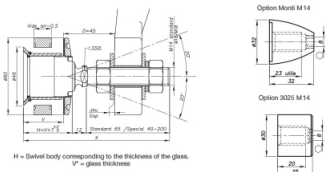

Components

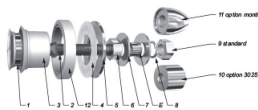

MARK.	QUANTITY	DESCRIPTION	REFERENCE
1	1	Sessel body	XZ Cr Ni Mo 17-12,2 as per EN 10088-3
2	1	Threaded Axis	XZ Cr Ni Mo 19,5-1 as per EN 10088-3
3	1	Steel ring grommet	AW 3000 as per EN 17533-3-162-0-6
4	1	Contact washer	White polypropylene propylfluorene
5	1	Countersunk head	XZ Cr Ni Mo 17-12,2 as per EN 10088-3
6	1	Nut DIN 934	A4
7	2	Washer	A4
8	1	Lock washer DIN 127	A4
9	1	Nut DIN 934	A4
10	1	3025 Cap-nut - Option	XZ Cr Ni Mo 17-12,2 as per EN 10088-3
11	1	Mordil cap-nut - Option	XZ Cr Ni Mo 17-12,2 as per EN 10088-3
12	1	Spouting ring	ACU44465/2017A (AU45) as per EN-173-3

How to Use

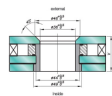

Method of Performance

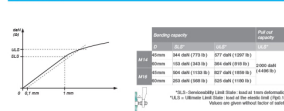

It is required to provide the following information with each request for price comparison: (1) - 10 items maximum, (2) - 6 maximum, (3) - 10 (4) - 10 maximum, (5) - length and diameter of the threaded part, (6) - no standard dimensions (DIN), (7) - 10 items (8) - the reference of the option to be used in request, (9) - the reference of the option to be used in the request.

© 2017 GlassParts Ltd. All rights reserved. This document is the property of GlassParts Ltd. and is not to be distributed or reproduced without the written consent of GlassParts Ltd.