

Glass Scratch Repair Kit Including 220V Bosch Grinder ( Model: F.GRK.001.220 )



Attributes:

**Product Code:** F.GRK.001.220

**Unit Of Sale:** Kit





After completion of the fine grinding, replace the No. 2 Grinding Pad with a polishing pad and proceed with polishing the glass.

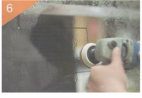

During the polishing process, add water continuously and observe the polishing effect throughout.



Once finished polishing, the scratch should now be repaired.

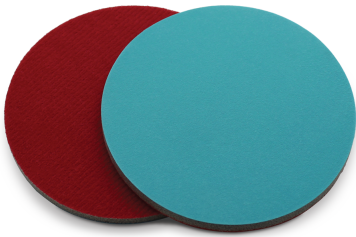

When performing a scratch repair on tempered glass, first use the Speed Adjustable Angle Grinder and the No. 1 Grinding Pad to perform a rough grind. Note that the grinding pad must be level with the glass and the speed adjusted to roughly 2500 - 3000 rpm.



When using the No. 1 Grinding Pad, you can perform the task without the need for water. Although, if using non-tempered glass, the temperature of the glass should be controlled so it does not overheat, which in turn could shatter the glass.



Once you have created a rough grind on the glass, replace the No. 1 Grinding Pad with the No. 2 Grinding Pad for a finer grind. Please note that the grinding area for the No. 2 Grinding Pad should be greater than the area for the No. 1 Grinding Pad to avoid any deformation.



In order to ensure the highest effectiveness of grinding, the glass powder on the Grinding Pad should be cleaned away periodically during the process.

