

**Dynamik 850mm X 2057mm Pre Cut Door Kit - Grey Anodised ( Model: G.DK.SG.SA.850 )**

Grey Anodised Standard Door Frame Kit pre cut to size to suit a 850mm x 2057mm door leaf.

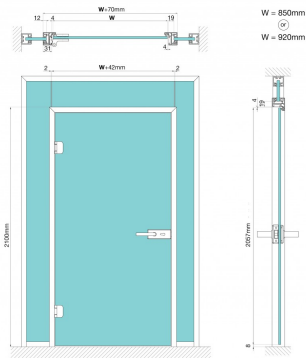

- All the cleats needed to assemble
- Pre mitred corners & gaskets.
- Hinges sold separately.
- Indicate the glass thickness to be used so the correct gaskets can be shipped.
- Available in anodised grey and black.

**Attributes:**

**Product Code:** G.DK.SG.SA.850

**Unit Of Sale:** Kit